

FLOODED BATTERY

31T-750 (12V95Ah)



CHARACTERISTICS

Item		Specifications
Nominal Voltage		12V
Nominal Capacity (20HR)		95Ah
Reserve Capacity		169min
Cold Cranking Amps@0°F (-18°C)		750A
Dimension	Length	329mm (13.0inches)
	Width	171mm (6.73inches)
	Container Height	215.5mm (8.48inches)
	Total Height (with Terminal)	237mm (9.33inches)
Approx Weight		23.6kg (52.0lbs)
Terminal		13
Cell layout		1
Hold-Down		B0
Case		Black-PP Material
Cover		Black-PP Material
Handle		TS9

APPLICATIONS

- Car start
- EV/HEV
- Engine start

GENERAL FEATURES

- High capacity and high CCA
- Long life
- Advanced lead-calcium alloy technology, maintenance-free design
- Patented venting system bring less water loss and prevent acid leakage
- OE quality certification

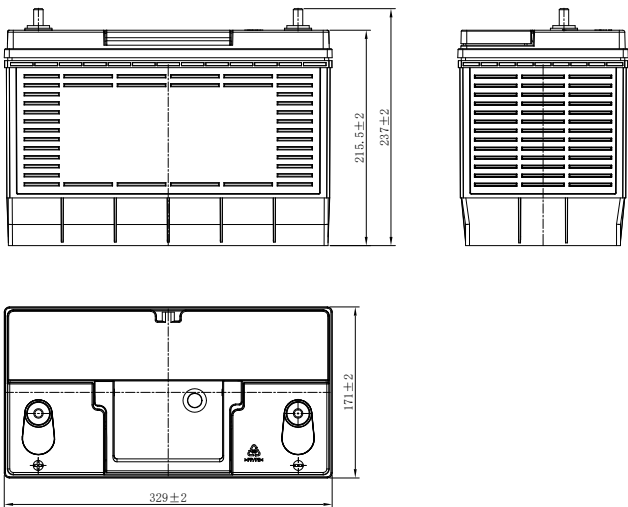
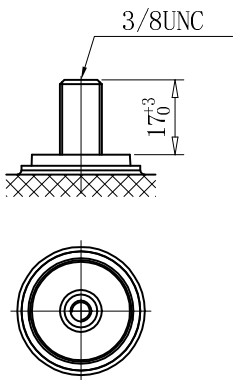

*Values are subject to variation of +/- 5% in normal manufacturing processes.